



The Traffic Cone

The Traffic Cone

The traffic cone is a staple of life in Los Angeles, they are ubiquitous in their dictation of our speedy lifestyle. The traffic cone stays upright because of its large bottom, and by design it is aesthetically quite eye catching.

Traffic cones were invented by Charles D. Scanlon, an American, who got the idea while working as a painter for the Street Painting Department of the City of Los Angeles. The patent for his invention was granted in 1943.

Proposal

A traffic cone shaped vase, which juxtaposes a hectic life with a little floral nicety. Orange colored clay, perhaps terracotta, could be the source of the color, and with its wide bottom, the vase will not topple over.

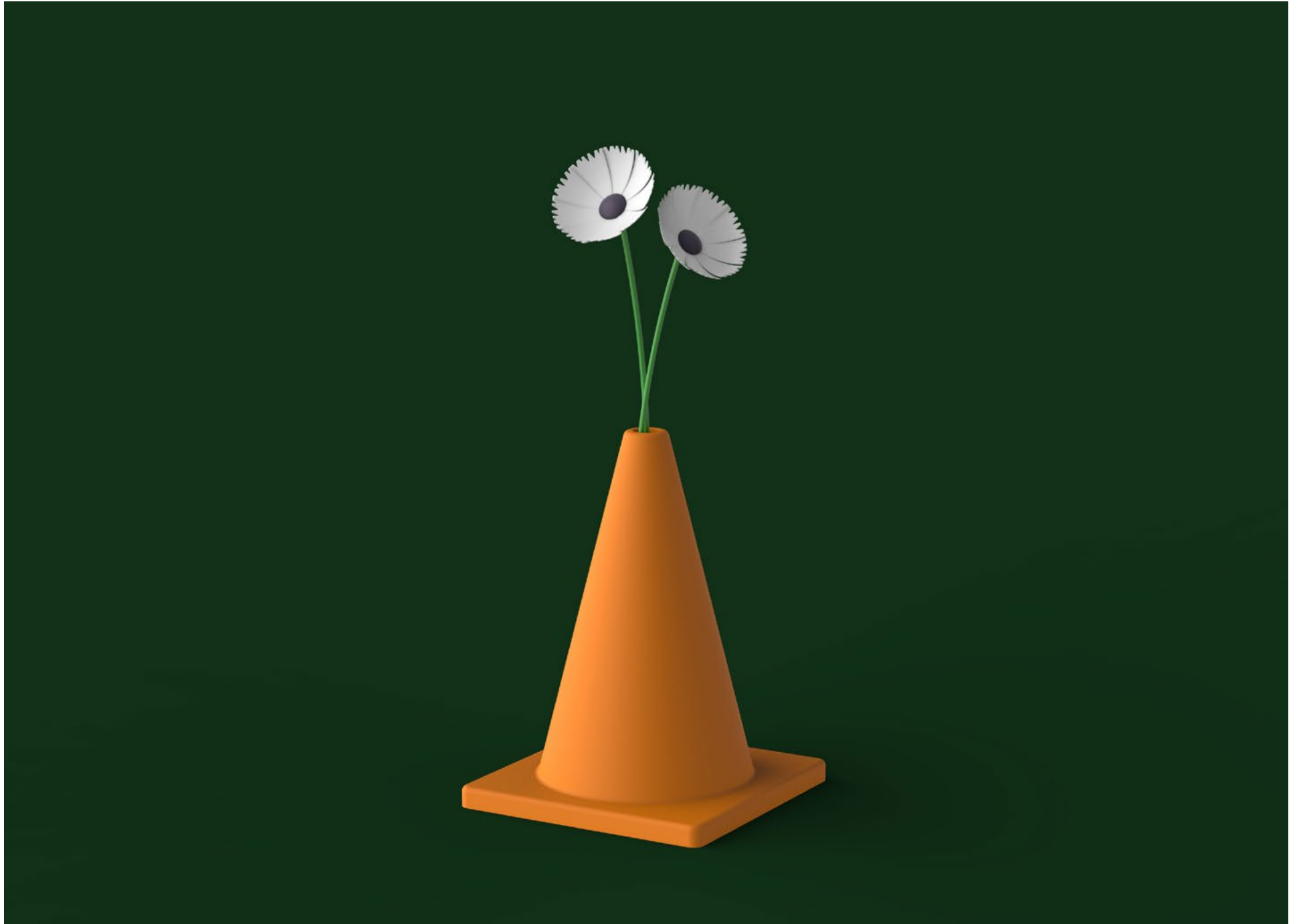

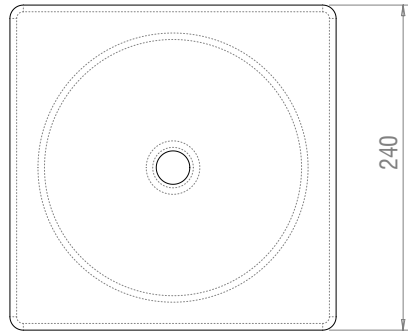

TOP

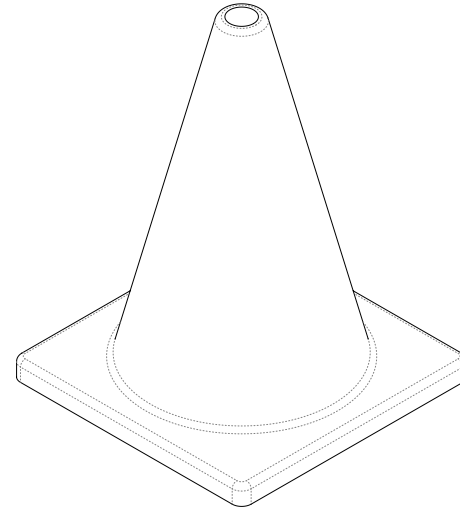

ISO

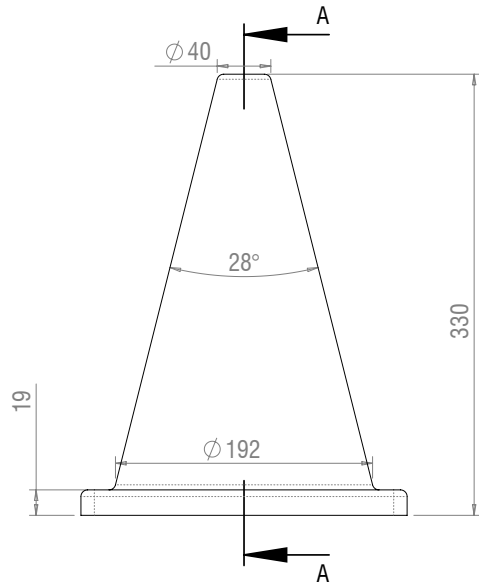

FRONT

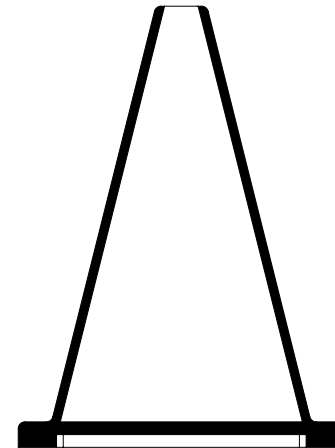

SECTION A-A